



TECHNICAL DATASHEET

Imagem indisponível

BS3 Submersible Pumps

Robust submersible pump for clean water in domestic and agricultural applications.

This pump is ideal for pumping clean water in various applications, including domestic supply, agricultural irrigation, hydropneumatic systems, and integration with solar panels. Designed with radial impellers and diffusers in polycarbonate and noryl, it combines efficiency and durability, reinforced by anti-wear elements and an external structure in AISI 304 stainless steel.

APPLICATIONS

- Water abstraction from 3" boreholes, reservoirs and water courses.
- Domestic water supply.
- Agricultural irrigation and gardens.
- Hydropneumatic systems.

TECHNICAL DATA

TECHNICAL SPECIFICATIONS

Type	Submersible for Clean Water
Material	Radial turbines and diffusers in Noryl reinforced with fiberglass
Motor Details	Hermetically sealed electric motor impregnated with protective resin
Protection	IP 68
Insulation	Class F
Max Temperature	35° C
Max. sand content	50 g/m ³
Discharge	1" 1/4

MOTOR CHARACTERISTICS

Voltage	230 V (1~) / 400 V (3~)
Frequency	50 Hz
Starts/Hour	20
Maximum immersion depth	150 m
Diameter	3" (76 mm)

DIMENSIONS

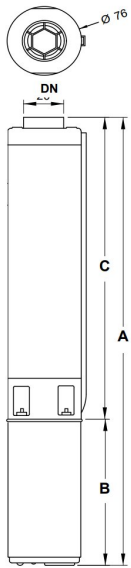

Model	A (mm)	B (mm)	C (mm)	DN
BS3 1/22	966,0	387,0	579,0	1" 1/4
BS3 1/38	1.246,0	387,0	859,0	1" 1/4
BS3 1/50	1.537,0	427,0	1.110,0	1" 1/4
BS3 1.5/22	966,0	387,0	579,0	1" 1/4
BS3 1.5/30	1.217,0	427,0	790,0	1" 1/4
BS3 1.5/35	1.234,0	427,0	807,0	1" 1/4
BS3 1.5/45	1.470,0	447,0	1.023,0	1" 1/4
BS3 2/16	933,0	387,0	546,0	1" 1/4
BS3 2/22	1.105,0	427,0	678,0	1" 1/4
BS3 2/30	1.301,0	447,0	854,0	1" 1/4
BS3 2/44	1.700,0	497,0	1.203,0	1" 1/4
BS3 3/16	933,0	387,0	546,0	1" 1/4
BS3 3/22	1.065,0	387,0	678,0	1" 1/4
BS3 3/30	1.281,0	427,0	854,0	1" 1/4
BS3 3/44	1.700,0	497,0	1.203,0	1" 1/4

CURVA DE PERFORMANCE (Q - HM)

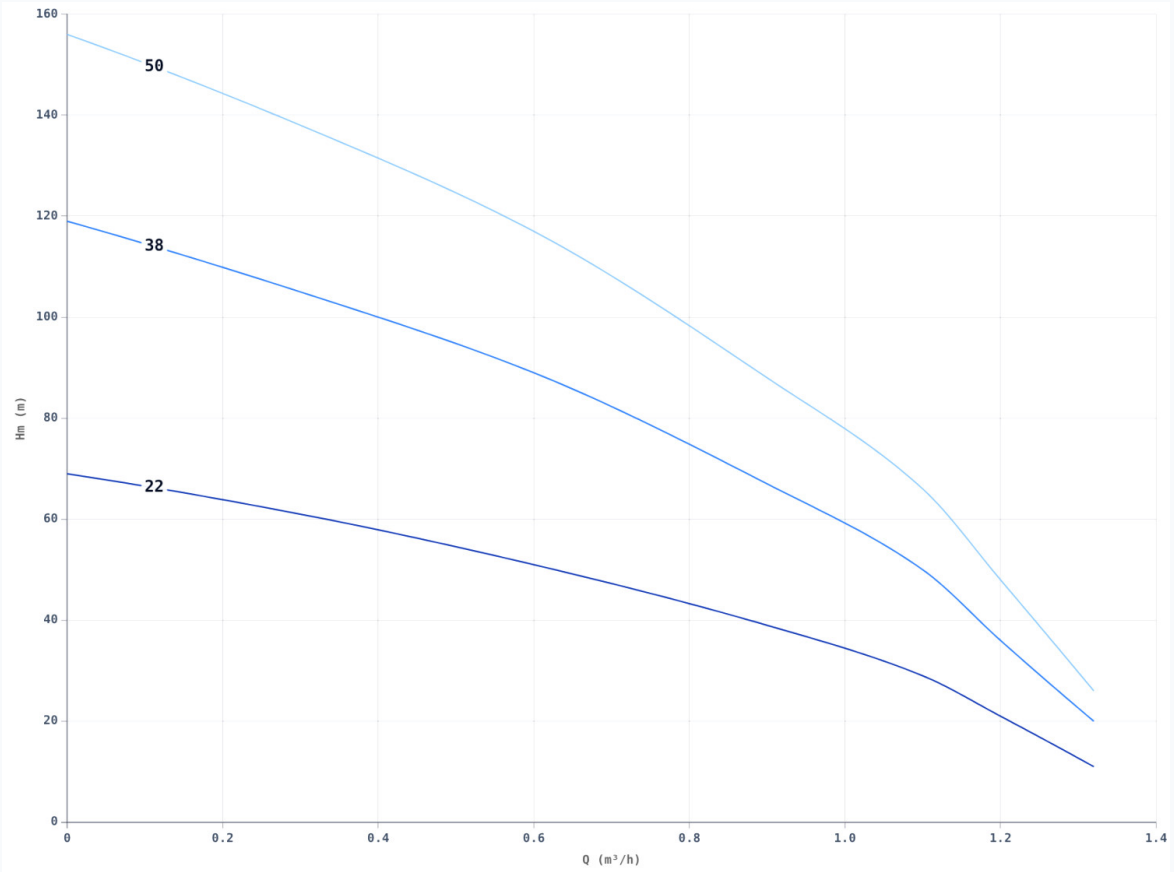

Curvas de caudal (Q) vs. altura manométrica (Hm)

Model	kW	HP	Amperage	m³/h	0	0.3	0.6	0.9	1.1	1.2	1.32
				Hm (m)							
BS3 1/22	0,37	0,50	4.7 / 1.4		69,0	61,0	51,0	39,0	29,0	21,0	11,0
BS3 1/38	0,37	0,50	4.7 / 1.4		119,0	105,0	89,0	67,0	50,0	36,0	20,0
BS3 1/50	0,55	0,75	5.7 / 1.8		156,0	138,0	117,0	88,0	66,0	48,0	26,0

CURVA DE PERFORMANCE (Q - HM)

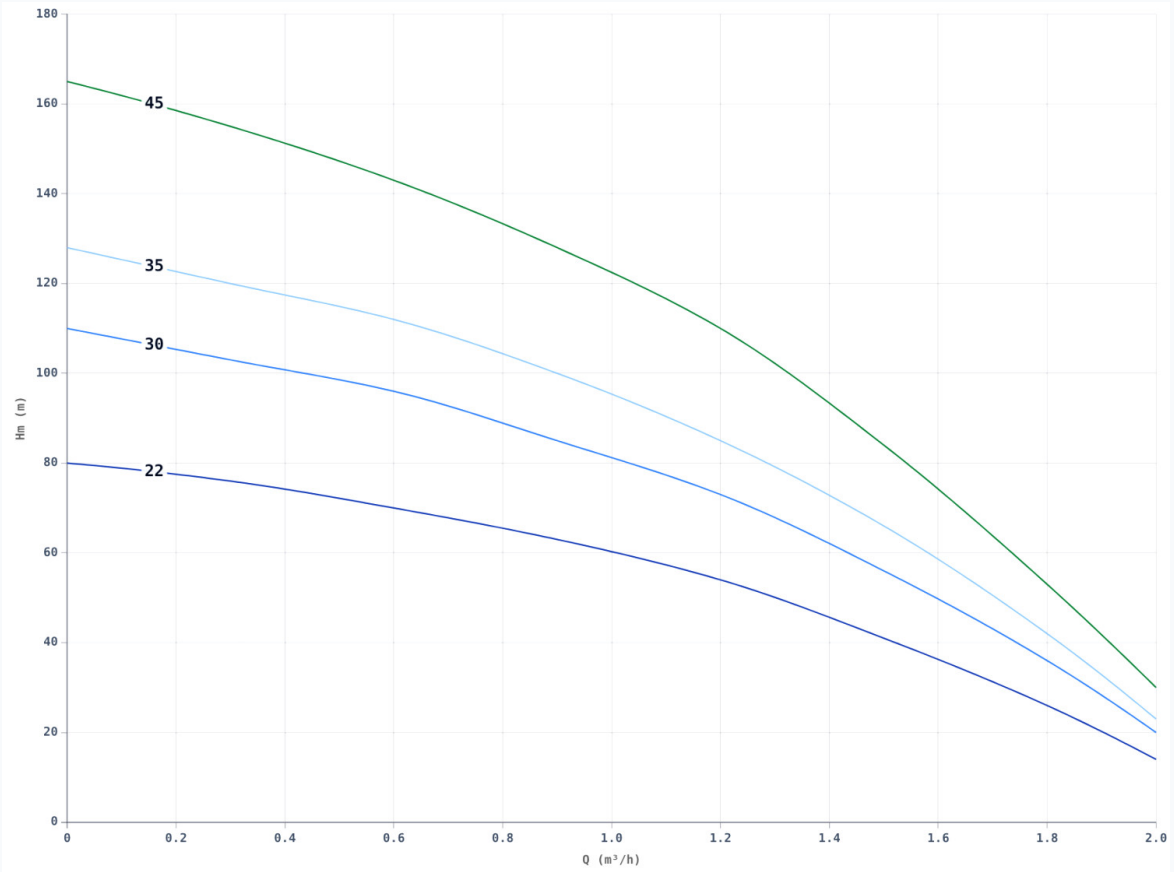

Curvas de caudal (Q) vs. altura manométrica (Hm)

Model	kW	HP	Amperage	m ³ /h	0	0.3	0.6	0.9	1.2	1.5	1.8	2
				Hm (m)								
BS3 1.5/22	0,37	0,50	4.7 / 1.4		80,0	76,0	70,0	63,0	54,0	41,0	26,0	14,0
BS3 1.5/30	0,55	0,75	5.7 / 1.8		110,0	103,0	96,0	85,0	73,0	56,0	36,0	20,0
BS3 1.5/35	0,55	0,75	5.7 / 1.8		128,0	120,0	112,0	100,0	85,0	66,0	42,0	23,0
BS3 1.5/45	0,75	1,00	7.1 / 3.1		165,0	155,0	143,0	128,0	110,0	84,0	53,0	30,0

CURVA DE PERFORMANCE (Q - Hm)

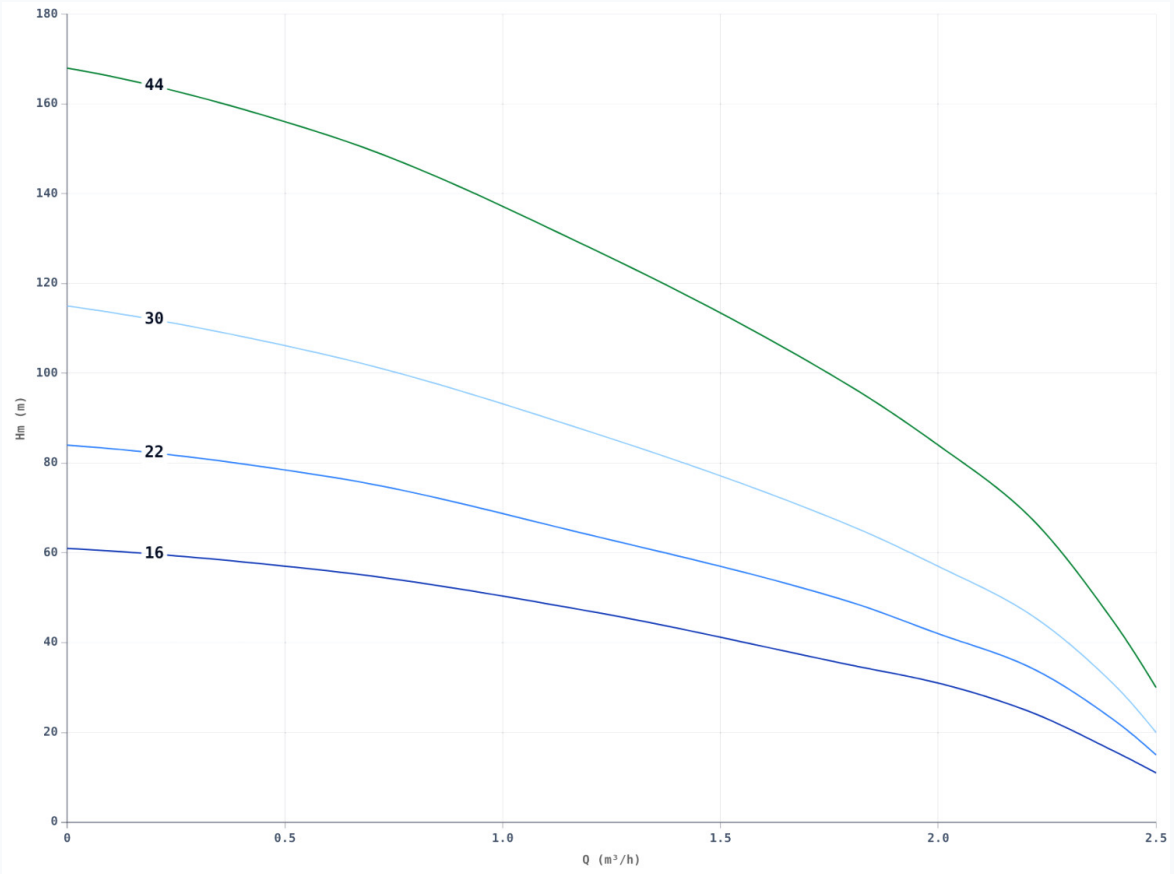

Curvas de caudal (Q) vs. altura manométrica (Hm)

Model	kW	HP	Amperage	m³/h	0	0.6	1.2	1.8	2	2.2	2.4	2.5
				Hm (m)								
BS3 2/16	0,37	0,50	4.7 / 1.4		61,0	56,0	47,0	35,0	31,0	25,0	16,0	11,0
BS3 2/22	0,55	0,75	5.7 / 1.8		84,0	77,0	64,0	49,0	42,0	35,0	23,0	15,0
BS3 2/30	0,75	1,00	7.1 / 3.1		115,0	104,0	87,0	66,0	57,0	47,0	31,0	20,0
BS3 2/44	1,10	1,50	10.4 / 4.3		168,0	153,0	128,0	97,0	84,0	69,0	45,0	30,0

CURVA DE PERFORMANCE (Q - Hm)

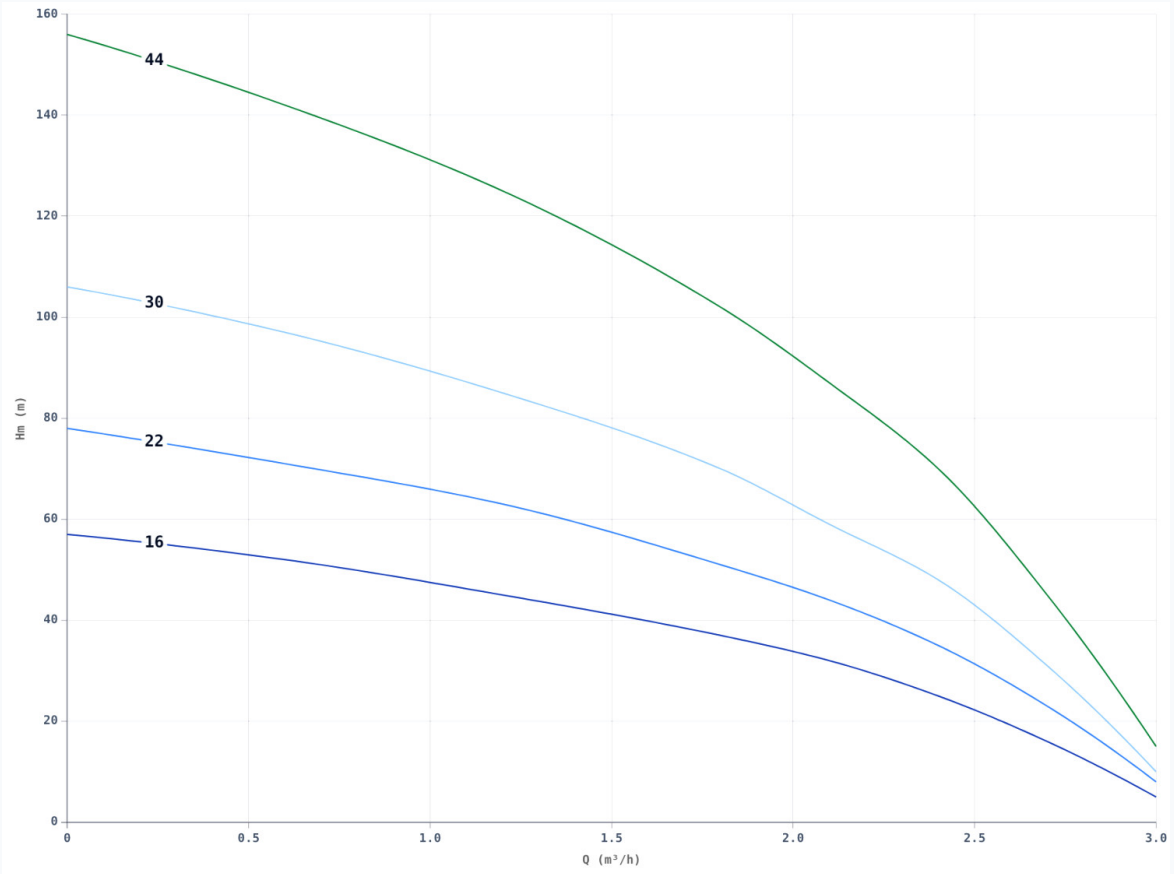

Curvas de caudal (Q) vs. altura manométrica (Hm)

Model	kW	HP	Amperage	m³/h	0	0.6	1.2	1.8	2.1	2.4	2.7	3
				Hm (m)								
BS3 3/16	0,37	0,50	4.7 / 1.4		57,0	52,0	45,0	37,0	32,0	25,0	16,0	5,0
BS3 3/22	0,55	0,75	5.7 / 1.8		78,0	71,0	63,0	51,0	44,0	35,0	23,0	8,0
BS3 3/30	0,75	1,00	7.1 / 3.1		106,0	97,0	85,0	70,0	59,0	48,0	31,0	10,0
BS3 3/44	1,10	1,50	10.4 / 4.3		156,0	142,0	125,0	102,0	87,0	70,0	45,0	15,0

LIST OF MATERIALS

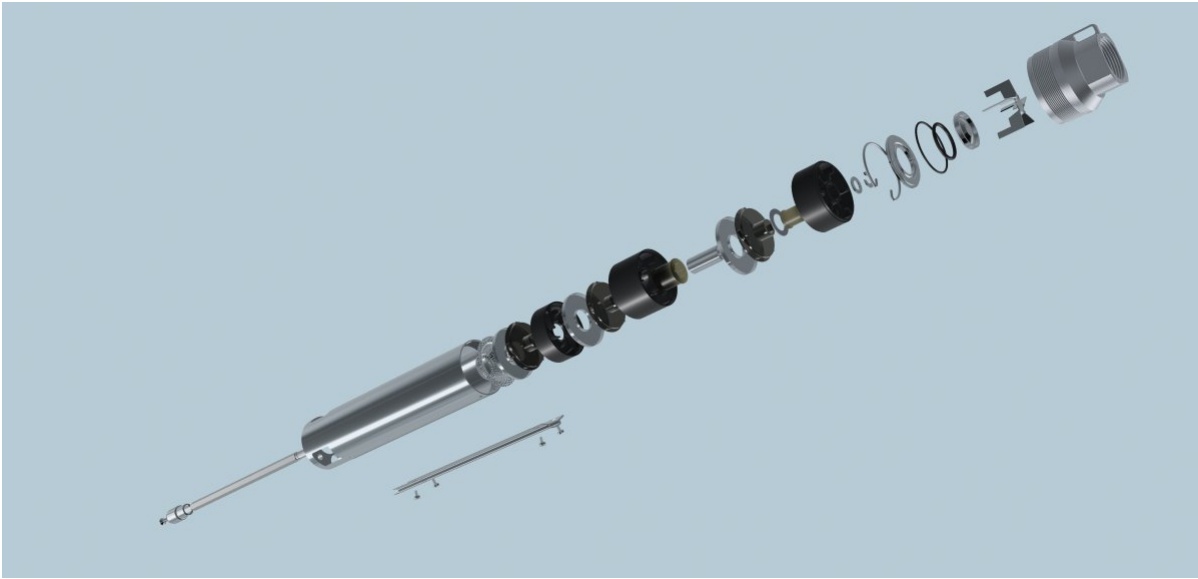

Pos.	Description	Material (Standard)
1	Câmara de Descarga	Aço inox. AISI 304
2	Válvula de Retenção	Aço inox. AISI 304
3	Camisa Externa	Aço inox. AISI 304
4	Turbina / Impulsor	Policarbonato / Noryl
5	Difusor	Policarbonato / Noryl
6	Veio	Aço inox. AISI 304
7	Acoplamento	Aço inox. AISI 304